

Master Chefs' Order Approved



INDUCTION-READY

# TRI=GEN™

by winco®

## NEXT GENERATION COOKWARE



Fry Pans  
Sauté Pans  
Sauce Pans  
Stock Pots  
Braziers



TRI=GEN™  
COOKWARE



## EXCALIBUR® Non-stick finish

Excalibur non-stick finish is reinforced externally with a proprietary stainless-steel alloy

**Highest performing commercial coating available**



## TRI-PLY INDUCTION-READY FRY PANS

- ◆ Handles offer excellent comfort and pan control, minimizing hand fatigue for high-volume operators
- ◆ Triangular positioned rivets provide strength - will not loosen in high-volume commercial kitchens
- ◆ Available in natural and Excalibur® non-stick finishes
- ◆ 5 sizes available

ITEM	DESCRIPTION	SIZE	UOM	CASE
TGFP-7	Natural Finish	7"	Each	1/6
TGFP-7NS	Non-stick	7"	Each	1/6
TGFP-8	Natural Finish	8"	Each	1/6
TGFP-8NS	Non-stick	8"	Each	1/6
TGFP-10	Natural Finish	10"	Each	1/6
TGFP-10NS	Non-stick	10"	Each	1/6
TGFP-12	Natural Finish	12"	Each	1/2
TGFP-12NS	Non-stick	12"	Each	1/2
TGFP-14	Natural Finish	14"	Each	1/2
TGFP-14NS	Non-stick	14"	Each	1/2

7"



8"



12"



10"



14"



TGFP-SERIES

PFOA  
FREE

NON-STICK FRY PANS

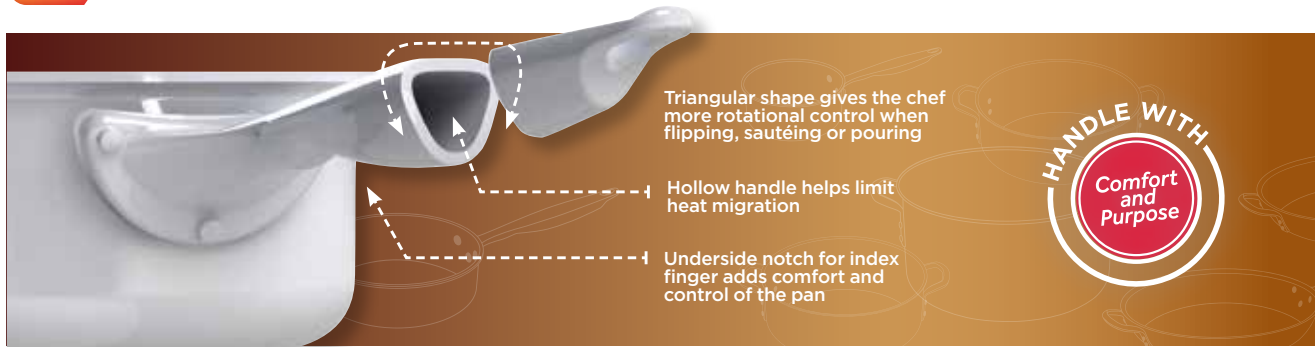



### TRI-PLY INDUCTION-READY SAUCE PANS

- ◆ Perfect for preparing many dishes with style and comfort
- ◆ Triangular positioned rivets provide strength - will not loosen in high-volume commercial kitchens
- ◆ Mirror finish exterior; satin finish interior
- ◆ 5 sizes available

ITEM	DESCRIPTION	SIZE	DIA	UOM	CASE
TGAP-2	Sauce Pan w/ Cover	1.5 Qt	6"	Set	1/6
TGAP-3	Sauce Pan w/ Cover	2.5 Qt	7"	Set	1/6
TGAP-4	Sauce Pan w/ Cover	3.5 Qt	8"	Set	1/4
TGAP-5	Sauce Pan w/ Cover	4.5 Qt	8.5"	Set	1/4
TGAP-7	Sauce Pan w/ Cover, Helper Hdl	7 Qt	9.5"	Set	1/2

Handles built for comfort and purpose.



TGAP-5

17-3/8"L x 9-1/4"W  
including handle  
5-1/8"H pan only



TGAP-2

14-1/2"L x 7"W  
including handle  
3-5/8"H pan only



TGAP-3

15-1/8" x 7-3/4"  
including handle  
4-1/8" pan only



TGAP-7

19-7/8"L x 10"W  
including handles  
6-1/2"H pan only



TGAP-4

16-5/8" x 8-1/2"  
including handle  
4-3/4" pan only

TGAP-SERIES



Visually  
stunning  
Highly  
functional



### TRI-PLY INDUCTION-READY SAUTÉ PANS

- ◆ Deep, straight sides for easy stirring, mixing or flipping food without spilling
- ◆ Sauté, brown or stir-fry with ease
- ◆ Mirror finish exterior; satin finish interior
- ◆ 4 sizes available

ITEM	DESCRIPTION	SIZE	DIA	UOM	CASE
TGET-2	Sauté Pan w/ Cover	2 Qt	8"	Set	1/6
TGET-3	Sauté Pan w/ Cover	3 Qt	9.5"	Set	1/6
TGET-6	Sauté Pan w/ Cover, Helper Hdl	6 Qt	12.5"	Set	1/4
TGET-7	Sauté Pan w/ Cover, Helper Hdl	7 Qt	14"	Set	1/2

2qt



TGET-2

16-5/8"L x 8-1/2"W  
including handle  
3-1/4"H pan only

6qt



TGET-6

24-1/4"L x 13-1/8"W  
including handles  
4-1/8"H pan only

3qt



TGET-3

18-1/8"L x 10"W  
including handle  
3-5/8"H pan only

7qt



TGET-7

26-1/8"L x 15"W  
including handles  
4"H pan only



TGET-SERIES



Triangular shaped handle with outward sloping top provides the chef with better control and a more comfortable thumb rest.

Compatible with  
Induction, Gas & Electric





### TRI-PLY INDUCTION-READY STOCK POTS

- ◆ Larger sizes for higher volume food preparation
- ◆ Securely riveted wide loop handles provide excellent stability, and roomy for handling with hot pads
- ◆ Mirror finish exterior; satin finish interior
- ◆ 6 sizes available

ITEM	DESCRIPTION	SIZE	DIA	UOM	CASE
TGSP-4	Stock Pot w/Cover	4.5 Qt	8.5"	Set	1/6
TGSP-6	Stock Pot w/Cover	6 Qt	8.5"	Set	1/6
TGSP-8	Stock Pot w/Cover	8 Qt	9.5"	Set	1/6
TGSP-12	Stock Pot w/Cover	12 Qt	12"	Set	1/4
TGSP-16	Stock Pot w/Cover	16 Qt	12.5"	Set	1/4
TGSP-20	Stock Pot w/Cover	20 Qt	14"	Set	1/4



12qt



TGSP-12

16-1/2"W including handles  
7-1/4"H pot only

4.5qt



TGSP-4

13"W including handles  
5-1/4"H pot only

16qt



TGSP-16

17-1/4"W including handles  
8-1/4"H pot only

6qt



TGSP-6

13"W including handles  
6-5/8"H pot only

20qt



TGSP-20

19"W including handles  
8-1/4"H pot only

8qt



TGSP-8

13-3/4"W including handles  
7-3/8"H pot only

TGSP-SERIES





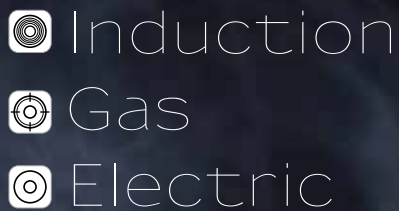

### TRI-PLY INDUCTION-READY BRAZIER

- ◆ Larger sizes for higher volume food preparation
- ◆ Securely riveted wide loop handles provide excellent stability, and roomy for handling with hot pads
- ◆ Mirror finish exterior; satin finish interior
- ◆ 2 sizes available

ITEM	DESCRIPTION	SIZE	DIA	UOM	CASE
TGBZ-12	Brazier w/Cover	12 Qt	13.5"	Set	1/4
TGBZ-14	Brazier w/Cover	14 Qt	14"	Set	1/4

12qt



TGBZ-12

18"W including handles  
5-1/2"H brazier only

14qt



TGBZ-14

19"W including handles  
6"H brazier only



TGBZ-SERIES

Packaging





SST-32



SSLB-25



SSSP-10



SSSP-6



SSLB-15



Riveted handles

## PREMIUM STAINLESS STEEL COOKWARE

- ◆ Commercial-quality 18/8 stainless steel offers excellent corrosion resistance and a bright finish
- ◆ Tri-ply heavy-duty bottom for even heat distribution
- ◆ Extra-sturdy riveted handles
- ◆ Induction ready



PREMIUM STAINLESS  
STEEL COOKWARE



### STOCK POTS WITH COVER INCLUDED

ITEM	DESCRIPTION	SIZE (DIA X HEIGHT)	UOM	CASE
SST-8	8 Qt	9-1/2" x 6-3/4"	Set	1/4
SST-12	12 Qt	11" x 7-1/8"	Set	1/4
SST-16	16 Qt	11" x 9-3/4"	Set	1/4
SST-20	20 Qt	11-3/4" x 10-1/4"	Set	1/4
SST-24	24 Qt	13-3/8" x 10-1/4"	Set	1/2
SST-32	32 Qt	14-1/4" x 11-3/4"	Set	1/2
SST-40	40 Qt	15-3/4" x 11-3/4"	Set	1/2
SST-60	60 Qt	17-3/4" x 14-1/4"	Set	1
SST-80	80 Qt	19-3/4" x 15-3/4"	Set	1

### REPLACEMENT COVERS

ITEM	UOM	CASE
SSTC-8	Each	6/12
SSTC-12	Each	6/12
SSTC-12	Each	6/12
SSTC-20	Each	6/12
SSTC-24	Each	6
SSTC-32	Each	6
SSTC-40	Each	6
SSTC-60	Each	6
SSTC-80	Each	6



### SAUCE PANS WITH COVER INCLUDED

ITEM	DESCRIPTION	SIZE (DIA X HEIGHT)	UOM	CASE
SSSP-2	2 Qt	6-3/8" x 3-3/4"	Set	1/6
SSSP-3	3 -1/2 Qt	8" x 4-1/4"	Set	1/6
SSSP-4	4 -1/2 Qt	8" x 5-1/2"	Set	1/6
SSSP-6	6 Qt	9-1/2" x 5"	Set	1/6
SSSP-7	7 -1/2 Qt w/Hdl	9-1/2" x 6-1/8"	Set	1/2
SSSP-10	10 Qt w/Hdl	11" x 6-1/8"	Set	1/2

### REPLACEMENT COVERS

ITEM	UOM	CASE
SSTC-2	Each	6
SSTC-8F	Each	6/12
SSTC-8F	Each	6/12
SSTC-8	Each	6/12
SSTC-8	Each	6/12
SSTC-12	Each	6/12



### BRAZIERS WITH COVER INCLUDED

ITEM	DESCRIPTION	SIZE (DIA X HEIGHT)	UOM	CASE
SSLB-8	8 Qt	11" x 5-1/8"	Set	1/4
SSLB-10	10 Qt	11-11/16" x 5-1/2"	Set	1/4
SSLB-15	15 Qt	14-1/4" x 5-1/2"	Set	1/4
SSLB-20	20 Qt	15-3/4" x 6"	Set	1/4
SSLB-25	25 Qt	17-3/4" x 6"	Set	1/2
SSLB-30	30 Qt	19-3/4" x 6"	Set	1/2

### REPLACEMENT COVERS

ITEM	UOM	CASE
SSTC-12	Each	6/12
SSTC-20	Each	6/12
SSTC-32	Each	6
SSTC-40	Each	6
SSTC-60	Each	6
SSTC-80	Each	6



### SAUTÉ PANS WITH COVER INCLUDED

ITEM	DESCRIPTION	SIZE (DIA X HEIGHT)	UOM	CASE
SSET-3	3 Qt	10" x 2-3/4"	Set	1/6
SSET-5	5 Qt	12-3/8" x 3-1/8"	Set	1/4
SSET-7	7 Qt	14" x 3-1/2"	Set	1/4

### REPLACEMENT COVERS

ITEM	UOM	CASE
SSTC-8	Each	6/12
SSTC-20	Each	6/12
SSTC-24	Each	6



## PREMIUM STAINLESS STEEL OMELET PANS



SSOP-11



SSOP-12



SSOP-SERIES



### STAINLESS STEEL OMELET PANS

- ◆ Tri-ply base for even heat distribution
- ◆ Induction compatible
- ◆ Riveted, sturdy handles

ITEM	DESCRIPTION	SIZE (DIA X H)	UOM	CASE
SSOP-11	11"	11" x 2-1/8"	Each	1/6
SSOP-12	12-1/2"	12-1/2" x 2-1/4"	Each	1/2



## PREMIUM STAINLESS STEEL FRY PANS



SSFP-11



SSFP-14



SSFP-SERIES

- ◆ Heavy-duty premium 18/8 stainless steel offers excellent corrosion resistance and a bright finish
- ◆ Tri-ply bottom for even heat distribution
- ◆ Extra-sturdy riveted handles



### STAINLESS STEEL FRY PANS

- ◆ Natural finish

ITEM	DESCRIPTION	SIZE	UOM	CASE
SSFP-8	8"	8" x 1-1/2"	Each	1/6
SSFP-9	9-1/2"	9-1/2" x 1-3/4"	Each	1/6
SSFP-11	11"	11" x 2"	Each	1/6
SSFP-12	12", Help Hdl	12-1/2" x 2"	Each	1/2
SSFP-14	14", Help Hdl	14-1/4" x 2-1/2"	Each	1/2



SSFP-11NS



SSFP-14NS



SSFP-SERIES



NON-STICK FRY PANS

#1 choice of  
professional  
chefs



### NON-STICK FRY PANS

- ◆ Excalibur® non-stick coating

ITEM	DESCRIPTION	SIZE	UOM	CASE
SSFP-8NS	8"	8" x 1-1/2"	Each	1/6
SSFP-9NS	9-1/2"	9-1/2" x 1-3/4"	Each	1/6
SSFP-11NS	11"	11" x 2"	Each	1/6
SSFP-12NS	12", Help Hdl	12-1/2" x 2"	Each	1/2
SSFP-14NS	14", Help Hdl	14-1/4" x 2-1/2"	Each	2

### COVERS FOR STAINLESS STEEL FRY PANS

ITEM	DESCRIPTION	UOM	CASE
SSTC-8F	Cover for 8" Fry Pans	Each	6/12
SSTC-8	Cover for 9-1/2" Fry Pans	Each	6/12
SSTC-12	Cover for 10" and 11" Fry Pans	Each	6/12
SSTC-12F	Cover for 12" Fry Pans	Each	6/12
SSTC-32	Cover for 14" Fry Pans	Each	6



## PREMIUM STAINLESS STEEL 7-PIECE COOKWARE SET

- ◆ Extra heavy-weight 18/8 stainless steel with double riveted handles
- ◆ Aluminum core, best for fast and even distribution of heat, is impact bonded between two layers of stainless steel for long-lasting use

ITEM	DESCRIPTION	UOM	CASE
SPC-7H	7-Pc Set	Set	1/2



SPC-7H



## PREMIUM STAINLESS STEEL 7PC COOKWARE SET

### Set Includes:

- ◆ 1 Qt Sauce Pan w/Cover
- ◆ 2 Qt Sauce Pan w/Cover
- ◆ 5 Qt Dutch Oven w/Cover
- ◆ 9-1/2" Sauté Pan

## EGG POACHER SET: ALUMINIZED STEEL PAN WITH INNER NON-STICK CUPS

When a meal calls for perfectly poached eggs, this 4-cup set gets the job done quickly. The glass lid provides easy monitoring without the loss of heat so eggs cook uniformly. Also functions as mini double-boiler to melt butter or chocolate, or steam individual custard portions.

- ◆ Suitable for all stove tops, including induction
- ◆ Handles on lid and pan covered with permanent cool-touch material for easier handling
- ◆ Interior of pan, tray and cups feature PTFE/PFOA-free non-stick coating for easy release and cleaning
- ◆ Dishwasher safe

ITEM	DESCRIPTION	UOM	CASE
CEP-4	Pan, Lid & 4-Cup Set	Set	1/6



## EGG POACHER SET

### Set Includes:

- ◆ Steel sauce pan
- ◆ Glass cover
- ◆ Inner tray with 4 cups, each with cool-touch handles



CEP-4

PAN INTERIOR,  
TRAY, & CUPS

## STAINLESS STEEL MIRROR-FINISH SAUCE PANS

- ◆ Triple-riveted handle

ITEM	DESCRIPTION	UOM	CASE
SAP-1.5	1-1/2 Qt	Each	12/36
SAP-2	2 Qt	Each	12/36

## MIRRORED SAUCE PANS



SAP-2

## DOUBLE POT HOOK

ITEM	DESCRIPTION	UOM	CASE
PH-2	Pot Hook	Each	24/240

## DOUBLE POT HOOK



PH-2



## STAINLESS STEEL DOUBLE BOILERS & PERFORATED STEAMERS



SSDB-20



SSDB-20S



SSDB-SERIES  
SSTC-SERIES



### STAINLESS STEEL DOUBLE BOILERS & PERF'D STEAMERS

- ◆ 18/8 Stainless steel; tri-ply bottom
- ◆ Cover included

ITEM	DESCRIPTION	SIZE	UOM	CASE
SSDB-8	8 Qt Double Boiler	9-1/2" x 6-3/4" & 7-1/2"	Set	1/6
SSDB-12	12 Qt Double Boiler	10-1/4" x 8-1/2" & 9-3/8"	Set	1/6
SSDB-16	16 Qt Double Boiler	11" x 9-5/8" & 10-1/2"	Set	1/4
SSDB-20	20 Qt Double Boiler	11-7/8" x 10-5/8" & 11-1/2"	Set	1/4
SSDB-8S	8 Qt Steamer/Pasta Cooker	9-1/2" x 6-3/4" & 7-1/2"	Set	1/6
SSDB-12S	12 Qt Steamer/Pasta Cooker	10-1/4" x 8-1/2" & 9-3/8"	Set	1/6
SSDB-16S	16 Qt Steamer/Pasta Cooker	11" x 9-5/8" & 10-1/2"	Set	1/4
SSDB-20S	20 Qt Steamer/Pasta Cooker	11-7/8" x 10-5/8" & 11-1/2"	Set	1/4

### REPLACEMENT COVERS

ITEM	DESCRIPTION	UOM	CASE
SSTC-8	Replacement Cover for 8 Qt	Each	6/12
SSTC-10	Replacement Cover for 12 Qt	Each	6
SSTC-12	Replacement Cover for 16 Qt	Each	6/12
SSTC-20	Replacement Cover for 20 Qt	Each	6/12

## CARBON STEEL PANS



CSFP-11



CSFP-SERIES



CSPP-11

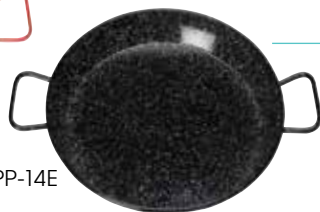

CSPP-14E



CSPP-35



### POLISHED CARBON STEEL FRENCH-STYLE FRY PANS

*Ideal for high-heat cooking and well suited for long pre-heating and searing.*

- ◆ Made in Spain
- ◆ Sturdy, riveted handle
- ◆ **Hand wash**, dry immediately and completely; rub on light coat of cooking oil and store in dry, non-humid area

ITEM	DESCRIPTION	UOM	CASE
CSFP-7	7-7/8"	Each	5
CSFP-8	8-5/8"	Each	8
CSFP-9	9-1/2"	Each	7
CSFP-11	10-3/8"	Each	4
CSFP-12	11-1/8"	Each	3



### CARBON STEEL PAELLA PANS

*Create and display authentic paella dishes, roasting meat, stir-fry, and much more!*

- ◆ Made in Spain
- ◆ **Hand wash**, dry thoroughly and store in dry area

ITEM	DESCRIPTION	FINISH	UOM	CASE
CSPP-7	7-7/8"	Polished	Each	12
CSPP-11	11"	Polished	Each	10
CSPP-14	14-1/8"	Polished	Each	5
CSPP-23	23-5/8"	Polished	Each	1
CSPP-35	35-1/2", 4 Hdl	Polished	Each	1
CSPP-11E	11"	Enameled	Each	10
CSPP-14E	14-1/8"	Enameled	Each	5
CSPP-23E	23-5/8"	Enameled	Each	1

**MIRROR FINISH STAINLESS STEEL CHINESE WOKS**

- ◆ Round bottom

ITEM	DESCRIPTION	UOM	CASE
WOK-14N	14" - Riveted Joint	Each	12
WOK-16N	16" - Riveted Joint	Each	12
WOK-14W	14" - Welded Handle	Each	12
WOK-16W	16" - Welded Handle	Each	12

**BLACK CARBON STEEL JAPANESE-STYLE WOKS**

- ◆ Integrated 6" long handle with reinforcing welded joint
- ◆ 1.2 mm thickness

ITEM	DESCRIPTION	UOM	CASE
WOK-34	14"	Each	12
WOK-36	16"	Each	12

**STAINLESS STEEL WOK COVERS**

ITEM	DESCRIPTION	UOM	CASE
WKCS-14	13-3/4"	Each	12/60
WKCS-15	15-3/8"	Each	12/48
WKCS-18	17-3/4"	Each	12/36

**STAINLESS STEEL WOK RING STAND**

ITEM	DESCRIPTION	UOM	CASE
WKR-8	8"	Each	12/120

**WOKS & ACCESSORIES**

Riveted Joint



WOK-16W

Round  
Bottom  
Woks

WOK-36



WKCS-14



WKR-8

**DELUXE HARD-ANODIZED ALUMINUM GRIDDLE**

- ◆ Great for use on all kinds of ranges
- ◆ Convert open range-top to griddle surface
- ◆ Raised handles are silicone wrapped, preventing heat transfer; provide easy transport

ITEM	DESCRIPTION	UOM	CASE
HAG-2012	19-5/8"L x 12-1/4"W	Each	1/6

**GRIDDLES**

HAG-2012



Flat griddle side

IGD-2095

**REVERSIBLE CAST IRON GRILL/GRIDDLE**

- ◆ Ribbed grill surface on one side, flat griddle on the other
- ◆ Pre-seasoned

ITEM	DESCRIPTION	UOM	CASE
IGD-2095	20"L x 9-1/2"W	Each	4

**FAJITA SERVERS**

- ◆ Attractive wooden underliner provides protective barrier between tabletop and hot platter; resists splitting or cracking under hot cast iron pan



ITEM	DESCRIPTION	UOM	CASE
FS-2	Fajita Server, 2-pc Set	Set	1/12
FS-2-UL	Replacement Underliner for FS-2	Each	12
ISP-3	Steak Platter with Gripper, 3-Pc Set	Set	1/12
ISP-3-UL	Replacement Underliner for ISP-3	Each	12

**FAJITA SERVERS**

FS-2

ISP-3

**SKILLET/PAN HANDLE SLEEVES**

- ◆ Heat-resistant up to 250°F (120°C)

ITEM	DESCRIPTION	SIZE	UOM	CASE
HDH-6C	Chili Peppers Cotton Sleeve	3-1/2" x 6-1/2"	Doz	1/24
HDH-7S	Cotton Sleeve	3-1/2" x 6-1/2"	Doz	1/24

**PAN HANDLE SLEEVES**

HDH-6C



HDH-7S





# GET COOKING WITH CAST

*Cookware that gets better with age!*

Our FireIron™ Cast collection is the perfect kitchen tool that can handle any commercial kitchen cooktop. The full-size cast iron pans come seasoned and ready to use, right out of the box!



Compatible with multiple cooking surfaces



## SAUTÉ, FRY, BOIL, BRAISE, BAKE, ROAST

Cook with confidence!

Achieve an excellent sear on the fine, smooth surface.



## EASY HANDLING

Wide handles to easily grasp and maneuver



## COMFORT GRIP

Thumbrest for comfortable grip when handling



**FIREIRON™ CAST IRON COOKWARE**

*Designed to last for generations, FireIron™ cast iron pans are pre-seasoned and induction ready. Great for kitchen-to-table service.*

- ◆ Fine, smooth surface for excellent sear; also sauté, fry, boil, braise, bake, and roast
- ◆ Wide-grip dual handles with thumbrest for comfortable grip and better handling

**FIREIRON™ CAST IRON SKILLETTS WITH DUAL HANDLES**

ITEM	DESCRIPTION	UOM	CASE
CASD-8	8" Dia	Each	6
CASD-10	10" Dia	Each	4
CASD-12	12" Dia	Each	4



CASD-12

CASD-SERIES



CAGP-10R



CAGP-10S

CAGP-SERIES

**FIREIRON™ CAST IRON GRILL PANS W/ HELPER HANDLE**

ITEM	DESCRIPTION	UOM	CASE
CAGP-10R	10-1/4" Dia	Each	4
CAGP-10S	10-1/2" Square	Each	4

**FIREIRON™ CAST IRON SKILLETTS**

ITEM	DESCRIPTION	UOM	CASE
CAST-6	6"	Each	6
CAST-8	8"	Each	6
CAST-10	10" with Helper Handle	Each	4
CAST-12	12" with Helper Handle	Each	4



CAST-6 with CAST-6UL

CAST-SERIES  
SKILLETTS**FIREIRON™ CAST IRON WOOD UNDERLINERS**

- ◆ Dual contoured handles for secure grip to safely transport hot skilletts
- ◆ Protect table/countertop surfaces from heat damage
- ◆ Hand wash only

ITEM	DESCRIPTION	UOM	CASE
CAST-6UL	Fits CAST-6	Each	12/48
CAST-8UL	Fits CAST-8	Each	12/48



CAST-8UL



CAST-6UL

**ROUND CAST IRON GRILL PAN**

ITEM	DESCRIPTION	UOM	CASE
IGL-10	10", Black Coating	Each	8



IGL-10





# ALUMINUM COOKWARE



Fry Pans | Sauce Pots | Braziers | Stock Pots | Sauté Pans

**INDUCTION  
READY**

INDUCTION  
READY

PFOA  
FREE



pg 212



**GLADIATOR™**

with



Non-stick

**SUPERIOR strength  
& scratch resistance,  
excellent release**

#1 choice of  
professional chefs

PFOA  
FREE

pg 213





Excellent quality  
for the price

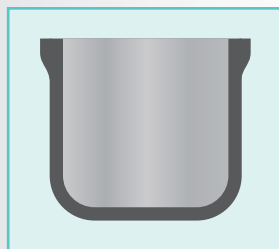

Strong and durable  
structure with  
reinforced edges



Ergonomic,  
sturdy handles  
for comfort



3003 aluminum  
for fast and even  
heat distribution,  
no hot spots

## 3003 ELEMENTAL ALUMINUM

6.0 mm,  
1/4" thickness

4.0 mm,  
3/16" thickness

pg 214-215



## MAJESTIC™

with



Non-stick

Strong, durable,  
scratch resistant,  
clean release

pg 213



## INDUCTION READY ALUMINUM COOKWARE



Induction ready pot/pan base



AFPI-10H



AFPI-SERIES



NON-STICK FRY PANS



Refer to  
page 64 for  
induction  
cooktops



AXSI-12



AXSI-SERIES



AXTI-3



## COVERS FOR ALUMINUM FRY PANS

ASP-2C  
ALPC-SERIES

ALPC-20

Hybrid technology bonds a stainless steel plate to aluminum cookware, as effective in utilizing induction technology as full stainless steel cookware.

- ◆ Deep drawn 3003 Aluminum body is durable and highly conductive, better than stainless steel cookware for quickly and evenly distributing heat
- ◆ Stainless steel bonded plate allows for magnetic contact with induction cooktops
- ◆ Thicker handles and heavier rivets than standard cookware allow for secure comfort in transporting cookware
- ◆ Can also be safely used with gas or electric ranges



### NATURAL FINISH INDUCTION READY ALUMINUM FRY PANS

- ◆ Ergonomic comfort handle is heat resistant to 500°F (260°C)

ITEM	DESCRIPTION	PLATE SIZE	UOM	CASE
AFPI-8H*	8"Dia	5"	Each	6
AFPI-10H	10"Dia	6-1/4"	Each	6
AFPI-12H	12"Dia	6-7/8"	Each	6

\*Compatible with all Winco® induction cookers.  
(May not be compatible with all induction cookers on the market.)



### NON-STICK INDUCTION READY ALUMINUM FRY PANS

- ◆ Quantum2® non-stick finish bonds to the aluminum for long-lasting, scratch-resistance
- ◆ Ergonomic comfort handle is heat resistant to 500°F (260°C)

ITEM	DESCRIPTION	PLATE SIZE	UOM	CASE
AFPI-8NH*	8"Dia	5"	Each	6
AFPI-10NH	10"Dia	6-1/4"	Each	6
AFPI-12NH	12"Dia	6-7/8"	Each	6

\*Compatible with all Winco® induction cookers.  
(May not be compatible with all induction cookers on the market.)



### INDUCTION READY STOCK POTS

- ◆ Reinforced rim adds extra durability, extending the integrity of the cookware
- ◆ 3003 Aluminum, 4.0mm, 3/16" thick
- ◆ 10" diameter opening

ITEM	DESCRIPTION	HEIGHT	PLATE SIZE	UOM	CASE
AXSI-12	12 Qt	9"H	7-1/2"	Each	1



### INDUCTION READY SAUTÉ PAN

- ◆ Thicker handle and heavier rivets than standard cookware allow for secure comfort when lifting and carrying
- ◆ 3003 Aluminum, 4.0mm, 3/16" thick

ITEM	DESCRIPTION	PLATE SIZE	UOM	CASE
AXTI-3	3 Qt	7-1/2"	Each	6

### COVERS FOR ALUMINUM FRY PANS

ITEM	DESCRIPTION	UOM	CASE
ASP-2C	For 8" Fry Pan	Each	12
ALPC-8SC	For 10" Fry Pan	Each	6
ALPC-20	For 12" Fry Pan	Each	6
ALPC-32	For 14" Fry Pan	Each	6

Constructed of 3003 series aluminum alloy with riveted heavy weight handles, the Gladiator fry pans will keep up with the rigorous demands of a commercial kitchen, in addition to providing excellent heat distribution for searing, browning and frying.

- ◆ 3.5mm thickness



### GLADIATOR™ NATURAL FINISH

ITEM	DESCRIPTION	UOM	CASE
AFP-7A	7"Dia	Each	6
AFP-8A	8"Dia	Each	6
AFP-10A	10"Dia	Each	6
AFP-12A	12"Dia	Each	6
AFP-14A	14"Dia	Each	6
AFP-7A-H	7"Dia with Sleeve	Each	6
AFP-8A-H	8"Dia with Sleeve	Each	6
AFP-10A-H	10"Dia with Sleeve	Each	6
AFP-12A-H	12"Dia with Sleeve	Each	6
AFP-14A-H	14"Dia with Sleeve	Each	6



### GLADIATOR™ EXCALIBUR® NON-STICK

- ◆ Excalibur® non-stick finish bonds to the aluminum for a long lasting, scratch-resistant finish

ITEM	DESCRIPTION	UOM	CASE
AFP-7XC	7"Dia	Each	6
AFP-8XC	8"Dia	Each	6
AFP-10XC	10"Dia	Each	6
AFP-12XC	12"Dia	Each	6
AFP-14XC	14"Dia	Each	6
AFP-7XC-H	7"Dia with Sleeve	Each	6
AFP-8XC-H	8"Dia with Sleeve	Each	6
AFP-10XC-H	10"Dia with Sleeve	Each	6
AFP-12XC-H	12"Dia with Sleeve	Each	6
AFP-14XC-H	14"Dia with Sleeve	Each	6

- ◆ Made of 3003 aluminum alloy, the Majestic™ fry pans offer exceptional performance at a great value
- ◆ Available in three finishes: Majestic™ mirror, Majestic™ natural & Majestic™ Quantum2® non-stick
- ◆ 3.5mm thickness



### MAJESTIC™ NATURAL FINISH

ITEM	DESCRIPTION	UOM	CASE
AFP-7S	7"Dia	Each	6
AFP-8S	8"Dia	Each	6
AFP-10S	10"Dia	Each	6
AFP-12S	12"Dia	Each	6
AFP-14S	14"Dia	Each	6



### MAJESTIC™ MIRROR FINISH

ITEM	DESCRIPTION	UOM	CASE
AFP-7	7"Dia	Each	6
AFP-8	8"Dia	Each	6
AFP-10	10"Dia	Each	6
AFP-12	12"Dia	Each	6
AFP-14	14"Dia	Each	6



### MAJESTIC™ QUANTUM2® NON-STICK

ITEM	DESCRIPTION	UOM	CASE
AFP-7NS	7"Dia	Each	6
AFP-8NS	8"Dia	Each	6
AFP-10NS	10"Dia	Each	6
AFP-12NS	12"Dia	Each	6
AFP-14NS	14"Dia	Each	6
AFP-7NS-H	7"Dia with Sleeve	Each	6
AFP-8NS-H	8"Dia with Sleeve	Each	6
AFP-10NS-H	10"Dia with Sleeve	Each	6
AFP-12NS-H	12"Dia with Sleeve	Each	6
AFP-14NS-H	14"Dia with Sleeve	Each	6

## GLADIATOR™ FRY PANS

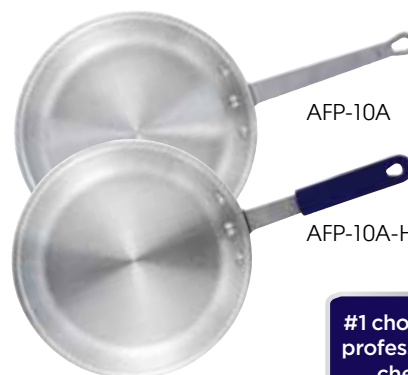

AFP-10A

AFP-10A-H

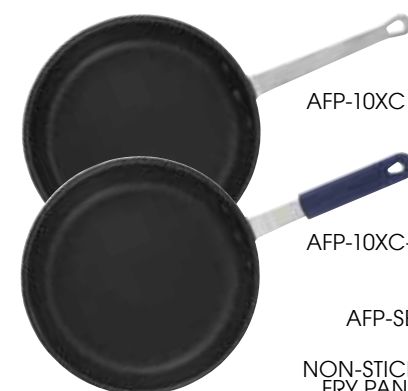

AFP-10XC

AFP-10XC-H

AFP-SERIES **NSF**  
NON-STICK FRY PANS **PFOA FREE**

## MAJESTIC™ FRY PANS



AFP-8S

AFP-10

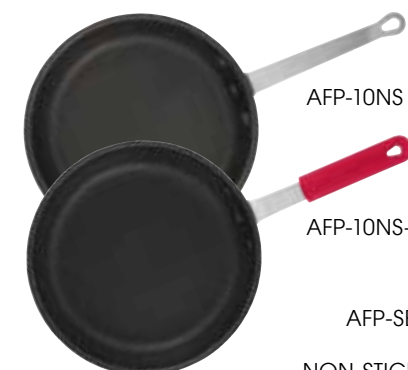

AFP-10NS

AFP-10NS-H

AFP-SERIES **NSF**  
NON-STICK FRY PANS **PFOA FREE**







## 3003 ELEMENTAL ALUMINUM COOKWARE



Sturdy handles

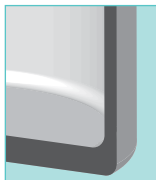

Extra thick reinforced base



ALBH-28



ASHP-60



ALHP-120



## ELEMENTAL ALUMINUM EXTRA-HEAVYWEIGHT COOKWARE

## 6.0 MM, 1/4" THICKNESS

- ◆ Extra-durable 6mm thick aluminum core ensures long-lasting performance through constant heating & washing
- ◆ 3003 Aluminum for superior heat distribution
- ◆ Riveted handles designed for strength & durability
- ◆ Wide base & high walls allow for recipe versatility

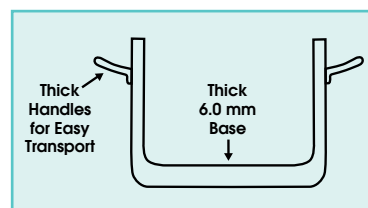

## EXTRA HEAVYWEIGHT ALUMINUM STOCK POTS

ITEM	DESCRIPTION	SIZE (DIA X HEIGHT)	UOM	CASE
ALHP-12	12 Qt	10-1/8" x 9-3/8"	Each	1
ALHP-16	16 Qt	11-3/8" x 10-1/4"	Each	1
ALHP-20	20 Qt	12-1/8" x 10-1/2"	Each	1
ALHP-24	24 Qt	12-1/8" x 11-3/8"	Each	1
ALHP-32	32 Qt	14-1/8" x 13"	Each	1
ALHP-40	40 Qt	14-3/4" x 14-1/2"	Each	1
ALHP-60	60 Qt	16-1/4" x 17-3/8"	Each	1
ALHP-80	80 Qt	19-1/4" x 17"	Each	1
ALHP-100	100 Qt	20-1/4" x 18-3/8"	Each	1
ALHP-120	120 Qt, 4 Hdls	21-5/8" x 19-1/2"	Each	1
ALHP-140	140 Qt, 4 Hdls	23-5/8" x 19-5/8"	Each	1
ALHP-160	160 Qt, 4 Hdls	23-5/8" x 21-7/8"	Each	1

Replaces AXHH-Series

## EXTRA HEAVYWEIGHT ALUMINUM SAUCE POTS

ITEM	DESCRIPTION	SIZE (DIA X HEIGHT)	UOM	CASE
ASHP-08	8 Qt	10-3/8" x 6-1/4"	Each	1
ASHP-14	14 Qt	12-1/8" x 7-1/2"	Each	1
ASHP-20	20 Qt	13-1/4" x 9"	Each	1
ASHP-26	26 Qt	14-1/8" x 10"	Each	1
ASHP-34	34 Qt	16-1/4" x 9-7/8"	Each	1
ASHP-40	40 Qt	18-1/4" x 10"	Each	1
ASHP-60	60 Qt	20" x 11-1/8"	Each	1

Replaces AXHA-Series

## EXTRA HEAVYWEIGHT ALUMINUM BRAZIER

ITEM	DESCRIPTION	SIZE (DIA X HEIGHT)	UOM	CASE
ALBH-15	15 Qt	14-1/8" x 5-3/8"	Each	1
ALBH-18	18 Qt	16-1/4" x 5-3/8"	Each	1
ALBH-24	24 Qt	18-1/4" x 5-3/8"	Each	1
ALBH-28	28 Qt	20-1/4" x 5-1/2"	Each	1
ALBH-35	35 Qt	22" x 5-1/2"	Each	1
ALBH-40	40 Qt	23-1/8" x 5-1/2"	Each	1

Replaces AXHB-Series

## COVERS

ITEM	UOM	CASE
ALPC-10	Each	6
ALPC-16	Each	6
ALPC-20	Each	6
ALPC-24	Each	6
ALPC-32	Each	6
ALPC-40	Each	6
ALPC-50	Each	6
ALPC-80	Each	6
ALPC-100	Each	6
ALPC-35BC	Each	6
ALPC-140	Each	6
ALPC-140	Each	6

Replaces AXS-Series

## COVERS

ITEM	UOM	CASE
ALPC-8SC	Each	6
ALPC-20	Each	6
ALPC-20SC	Each	6
ALPC-32	Each	6
ALPC-50	Each	6
ALPC-40SC	Each	6
ALPC-100	Each	6

Replaces AXS-Series

## COVERS

ITEM	UOM	CASE
ALPC-32	Each	6
ALPC-50	Each	6
ALPC-40SC	Each	6
ALPC-100	Each	6
ALPC-35BC	Each	6
ALPC-40BC	Each	6

Replaces AXS-Series





ALST-80



ASSP-40



Sturdy handles

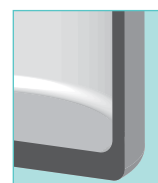

Extra thick reinforced base



ASET-5



## ELEMENTAL ALUMINUM HEAVYWEIGHT COOKWARE

### 4.0 MM, 3/16" THICKNESS

- ◆ Durable 4mm thick aluminum core ensures long-lasting performance with constant heating & washing
- ◆ 3003 Aluminum for superior heat distribution
- ◆ Riveted handles designed for strength & durability
- ◆ Wide base & high walls allow for recipe versatility

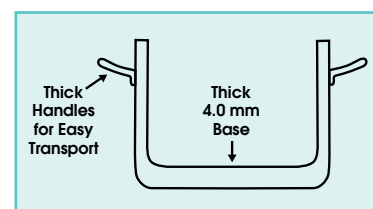

### HEAVYWEIGHT ALUMINUM STOCK POTS

ITEM	DESCRIPTION	SIZE (DIA X HEIGHT)	UOM	CASE
ALST-8	8 Qt	9-3/8" x 7-1/2"	Each	1
ALST-10	10 Qt	10-1/8" x 8-1/4"	Each	1
ALST-12	12 Qt	10-1/8" x 9-3/8"	Each	1
ALST-16	16 Qt	11-3/8" x 10-1/4"	Each	1
ALST-20	20 Qt	12-1/8" x 10-1/2"	Each	1
ALST-24	24 Qt	13" x 11-3/8"	Each	1
ALST-32	32 Qt	14-1/8" x 13"	Each	1
ALST-40	40 Qt	14-3/4" x 14-1/2"	Each	1
ALST-50	50 Qt	16-1/4" x 15"	Each	1
ALST-60	60 Qt	16-1/4" x 17-3/8"	Each	1
ALST-80	80 Qt	19-1/4" x 17"	Each	1
ALST-100	100 Qt	20-1/4" x 18-3/8"	Each	1

Replaces AXS-Series

### HEAVYWEIGHT ALUMINUM SAUCE POTS

ITEM	DESCRIPTION	SIZE (DIA X HEIGHT)	UOM	CASE
ASSP-08	8 Qt	10-3/8" x 6-1/4"	Each	1
ASSP-14	14 Qt	12-1/8" x 7-1/2"	Each	1
ASSP-20	20 Qt	13-1/4" x 9"	Each	1
ASSP-26	26 Qt	14-1/8" x 10"	Each	1
ASSP-34	34 Qt	16-1/4" x 9-7/8"	Each	1
ASSP-40	40 Qt	18-1/4" x 10"	Each	1

Replaces AXAP-Series

### HEAVYWEIGHT ALUMINUM BRAZIERS

ITEM	DESCRIPTION	SIZE (DIA X HEIGHT)	UOM	CASE
ALB-15	15 Qt	14-1/8" x 5-3/8"	Each	1
ALB-18	18 Qt	16-1/4" x 5-3/8"	Each	1
ALB-24	24 Qt	18-1/4" x 5-3/8"	Each	1
ALB-28	28 Qt	20-1/4" x 5-1/2"	Each	1
ALB-35	35 Qt	22" x 5-1/2"	Each	1
ALB-40	40 Qt	23-1/8" x 5-1/2"	Each	1

Replaces AXBZ-Series

### HEAVYWEIGHT ALUMINUM SAUTÉ PANS (NON-NSF)

ITEM	DESCRIPTION	SIZE	UOM	CASE
ASET-3	3 Qt	10-3/8" x 2-5/8"	Each	6
ASET-5	5 Qt	12-3/8" x 2-7/8"	Each	6
ASET-7	7 Qt	14-1/4" x 2-7/8"	Each	6

Replaces AXST-Series

### COVERS

ITEM	UOM	CASE
ALPC-8	Each	6
ALPC-10	Each	6
ALPC-10	Each	6
ALPC-16	Each	6
ALPC-20	Each	6
ALPC-24	Each	6
ALPC-32	Each	6
ALPC-40	Each	6
ALPC-50	Each	6
ALPC-50	Each	6
ALPC-80	Each	6
ALPC-100	Each	6

Replaces AXS-Series

### COVERS

ITEM	UOM	CASE
ALPC-8SC	Each	6
ALPC-20	Each	6
ALPC-20SC	Each	6
ALPC-32	Each	6
ALPC-50	Each	6
ALPC-40SC	Each	6

Replaces AXS-Series

### COVERS

ITEM	UOM	CASE
ALPC-32	Each	6
ALPC-50	Each	6
ALPC-40SC	Each	6
ALPC-100	Each	6
ALPC-35BC	Each	6
ALPC-40BC	Each	6

Replaces AXS-Series

### COVERS

ITEM	UOM	CASE
ALPC-8SC	Each	6
ALPC-20	Each	6
ALPC-32	Each	6

Replaces AXS-Series

## PAN HANDLE SLEEVES



PH-811W

Refer to  
page 255  
for oven  
mitts



## PAN GRABBER MITT

- ◆ Heat-resistant up to 400°F (205°C)
- ◆ Comfortable elastic wrist strap assists while handling hot baking sheets or pan handles

ITEM	DESCRIPTION	SIZE	UOM	CASE
PH-811W	Terry Cloth Mitt	11"L x 8"W	Doz	15



AFP-1HR



AFP-1HX



AFP-2HR



AFP-2HX



AFP-3HR



AFP-3HX

## REMOVABLE SILICONE SLEEVES FOR FRY &amp; SAUCE PANS

- ◆ Heat-resistant up to 450°F (230°C)

ITEM	DESCRIPTION	COLOR	UOM	CASE
AFP-1HR	Fits AFP-7, -8, ASP-1, -2	Red	Each	12/120
AFP-2HR	Fits AFP-10, -12, ASP-3, -4, -5, -7, ASFP-11, AXST-3	Red	Each	12/120
AFP-3HR	Fits AFP-14, ASP-10, AXST-5, -7	Red	Each	12/120
AFP-1HX	Fits AFP-7, -8, ASP-1, -2	Blue	Each	12/120
AFP-2HX	Fits AFP-10, -12, ASP-3, -4, -5, -7, ASFP-11, AXST-3	Blue	Each	12/120
AFP-3HX	Fits AFP-14, ASP-10, AXST-5, -7	Blue	Each	12/120

Refer to  
page 285  
for the full  
Allergen-  
Free range



AFP-10HP

## ALLERGEN-FREE SILICONE SLEEVE

ITEM	DESCRIPTION	COLOR	UOM	CASE
AFP-10HP	Fits AFP-10, ASFP-11, ASP-3, -4	Purple	Each	1/120

## HEAVY-DUTY ALUMINUM SHEET PANS

Refer to  
page 238  
for the full  
sheet pan  
range



## HEAVY-DUTY ALUMINUM SHEET PANS

Reinforced with galvanized wire, count on Winco® sheet pans to hold their shape in high-heat oven temperatures during baking, roasting or broiling.

- ◆ Closed bead with galvanized wire for rust resistance and reinforcement
- ◆ Made of 3003 aluminum

ITEM	DESCRIPTION	SIZE	GAUGE	UOM	CASE
ALXP-1200	Full-Size Open Bead, NSF	18" x 26"	12	Each	12
ALXP-2618H	Full-Size Closed Bead	18" x 26"	16	Each	12



Open bead

NSF ALXP-1200



## HEAVY-DUTY ALUMINUM DOUBLE ROASTERS

- ◆ Lock in steam and enhance flavors
- ◆ Straps add strength and lugs hold cover in place when used together
- ◆ 10 gauge aluminum

ITEM	DESCRIPTION	SIZE	UOM	CASE
ALRP-1824	Roaster with Straps and Handles	24"L x 18"W x 4-1/2"H	Each	2
ALRP-1824L	Roaster with Straps, Lugs and Handles	24"L x 18"W x 4-1/2"H	Each	2

## ALUMINUM ROASTING PANS

Refer to  
page 277 for  
thermometers



ALRP-1824



ALRP-1824L



## HEAVY-DUTY ALUMINUM BAKING/ROASTING PANS

- ◆ 12 gauge aluminum

ITEM	DESCRIPTION	SIZE	UOM	CASE
ALRP-1826	Pan without Handles	25-3/4"L x 17-3/4"W x 2-1/4"H	Each	3
ALRP-1826H	Pan with Handles	25-3/4"L x 17-3/4"W x 3-1/2"H	Each	3



ALRP-1826H



ALRP-1826

## ALUMINUM BAKING/ROASTING PAN

ITEM	DESCRIPTION	SIZE	UOM	CASE
ALBP-1218	Pan with Handles	17-3/4"L x 11-1/2"W x 2-1/4"H	Each	6/24



ALBP-1218



## ALUMINUM GYRO PAN



NSF AGP-10

Curved front



## 10" ALUMINUM GYRO PAN

*The perfect pan for catching meat that is carved off of a gyro cone when rotating on a vertical broiler.*

- ◆ Ergonomically designed, insulated silicone handle is heat-resistant up to 450°F (230°C)

ITEM	DESCRIPTION	UOM	CASE
AGP-10	10" Gyro Pan	Each	12



## HEAVY-DUTY ALUMINUM SAUCE PANS



ASP-2SW

NSF ASP-SERIES



## ALUMINUM STRAIGHT-SIDED SAUCE PANS

- ◆ 3003 Aluminum, 4.0mm thickness
- ◆ Broad base offers widest area for optimal heating; ideal for cooking sauces or vegetables

## COVER

ITEM	DESCRIPTION	UOM	CASE
ASP-2C	Cover for 2-1/2 Qt	Each	12



## ALUMINUM TAPERED SAUCE PANS

- ◆ 3003 Aluminum, 3.0mm thickness
- ◆ Flared sides for easier stirring and churning

ITEM	DESCRIPTION	SIZE (DIA X H)	UOM	CASE
ASP-1	1-1/2 Qt	6-1/8" x 4-1/8"	Each	12
ASP-2	2-1/2 Qt	8" x 4-1/2"	Each	12
ASP-3	3-3/4 Qt	8-7/8" x 4-1/2"	Each	12
ASP-4	4-1/4 Qt	9-1/4" x 5"	Each	12
ASP-5	5 Qt	10-1/8" x 5-1/2"	Each	12
ASP-7	7 Qt, Help Hdl	10-3/4" x 5-1/2"	Each	6
ASP-10	10 Qt, Help Hdl	11-1/2" x 5-3/4"	Each	6



ASP-5

ASP-5C

## COVERS

ITEM	DESCRIPTION	UOM	CASE
ASP-1C	Cover for 1-1/2 Qt	Each	12
ASP-2C	Cover for 2-1/2 Qt	Each	12
ASP-3C	Cover for 3-3/4 Qt	Each	12
ASP-4C	Cover for 4-1/4 Qt	Each	12
ASP-5C	Cover for 5 Qt	Each	12
ASP-7C	Cover for 7 Qt	Each	12
ASP-10C	Cover for 10 Qt	Each	12

NSF ASP-SERIES



## ALUMINUM STIR FRY PANS

- ◆ 3003 Aluminum, 4.0mm thickness
- ◆ Ergonomic, heat-resistant silicone handle

ITEM	DESCRIPTION	SIZE (DIA X H)	UOM	CASE
ASFP-11	Natural Finish	11" x 3-5/8"	Each	6
ASFP-11NS	Non-stick, Quantum2® Coating	11" x 3-5/8"	Each	6



## ALUMINUM STIR FRY PANS



ASFP-11



ASFP-11NS

ASFP-SERIES



ASFP-11NS



## ALUMINUM PASTA COOKER SET

- ◆ Heavyweight 3003 aluminum pot, 3.5mm
- ◆ Includes 4 stainless steel inserts, 0.7mm thick
- ◆ Handles are heat-resistant up to 500°F (260°C)



ITEM	DESCRIPTION	UOM	CASE
APS-20	20 Qt Pasta Cooker Set	Set	1
APS-INS	Quarter-Size S/S Inset	Each	4
APS-PT	Replacement Pot	Each	1



## PASTA COOKER SET



APS-20

## ALUMINUM STEAMER BASKETS

ITEM	DESCRIPTION	UOM	CASE
ALSB-20	20 Qt Fits ALST-20, ALHP-20, AXHH-20, & AXS-20	Each	1
ALSB-32	32 Qt Fits ALST-32, ALHP-32, AXHH-32, & AXS-32	Each	1
ALSB-40	40 Qt Fits ALST-40, ALHP-40, AXHH-40, & AXS-40	Each	1
ALSB-60	60 Qt Fits ALST-60, ALHP-60, AXHH-60, & AXS-60	Each	1
ALSB-80	80 Qt Fits ALST-80, ALHP-80, AXHH-80, & AXS-80	Each	1

## ALUMINUM STEAMER BASKETS



ALSB-32

## NYLON BRISTLE POT SCRUBBING BRUSHES

ITEM	DESCRIPTION	UOM	CASE
BRN-8P	8" Nylon Brush	Each	12/72
BRN-20P	20" Nylon Brush	Each	12/72

## POT SCRUBBING BRUSHES



BRN-20P



BRN-8P

## COIR BRISTLE WOODEN HANDLE POT BRUSHES

ITEM	DESCRIPTION	UOM	CASE
BRP-10	10" Coir BRush	Each	12/72
BRP-20	20" Coir Brush	Each	6/48



BRP-20



BRP-10





# FRY BASKET STRUCTURE

NICKEL PLATED  
NON-WELDED, ONE-PIECE  
CONSTRUCTION

Corners reinforced  
with heavy-gauge wire

One piece from handle to hook



Heavy-gauge wire  
handle with high-  
temperature resistant  
colored plastic coating

## FRY BASKETS DIMENSIONS

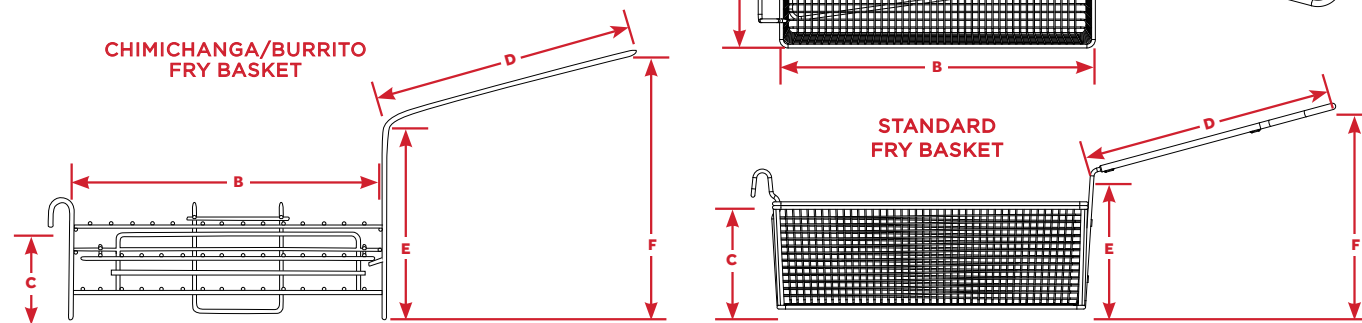

MODEL NO.	PRODUCT NAME	DIMENSIONS (IN.)					
		Length B	Width A	Height C	Handle D	Handle E	Handle F
FB-03	Chimichanga/Burrito Fry Basket	11-1/2	6	3-7/8 (4-5/8 with hook)	8	8-1/4	12
FB-05	Fry Basket	11	5-3/8	4-1/4	10-1/2	6-1/4	8-1/2
FB-10	Fry Basket	12-1/4	6-1/2	5-1/4	10-1/2	9-1/4	11-1/2
FB-20	Fry Basket	13-1/4	5-3/4	5-5/8	10-1/2	9-1/4	10-3/4
FB-25	Fry Basket	12-7/8	6-5/8	5-1/4	10-1/2	9	10-1/8
FB-30	Fry Basket	13-1/4	6-1/2	6	10-1/2	9	11
FB-35	Fry Basket	13-3/8	9-1/2	6-1/8	10-1/2	9-1/4	11-1/4
FB-40	Fry Basket	17	8-3/8	6	12	8	10-7/8

## FRY BASKET ACCESSORIES



### FRY BASKET DIVIDER

- ◆ Handle is removable for easy cleaning
- ◆ Divide a fryer basket into multiple compartments for small-batch, portioned frying
- ◆ Fits Winco® fry basket models FB-10, FB-25, FB-30 (6-1/2"W)

ITEM	DESCRIPTION	UOM	CASE
FB-DIV	Fry Basket Divider	Each	12/72



Divide fry baskets for  
smaller batches  
Shown with FB-25



FB-DIV



FB-PB

### FRY BASKET PRESSES

- ◆ Heavy gauge wire handles with high-temperature resistant colored plastic coating
- ◆ Nickel plated

ITEM	DESCRIPTION	COLOR	UOM	CASE
FB-PS	Press Fits FB-10 & FB-20, 11" Handle	Red	Each	20
FB-PB	Press Fits FB-30, 11" Handle	Red	Each	20



## NICKEL PLATED FRY BASKETS

- ◆ One-piece construction, non-welded structure
- ◆ Reinforced, strong, long-lasting frame
- ◆ Heavy gauge wire handles with high-temperature resistant colored plastic coating

ITEM	DESCRIPTION	COLOR	UOM	CASE
FB-05	11" x 5-3/8" x 4-1/4", 10-1/2" Handle	Black	Each	6
FB-10	12-1/4" x 6-1/2" x 5-1/4", 10-1/2" Handle	Orange	Each	6
FB-20	13-1/4" x 5-3/4" x 5-5/8", 10-1/2" Handle	Blue	Each	6
FB-25	12-7/8" x 6-5/8" x 5-1/4", 10-1/2" Handle	Red	Each	6
FB-30	13-1/4" x 6-1/2" x 6", 10-1/2" Handle	Green	Each	6
FB-35	13-3/8" x 9-1/2" x 6-1/8", 10-1/2" Handle	Grey	Each	6
FB-40	17" x 8-3/8" x 6", 12" Handle	Yellow	Each	6



Packaging lists the models that each FB- item fits

## FRY BASKETS

Refer to  
www.wincous.com  
for fit guide

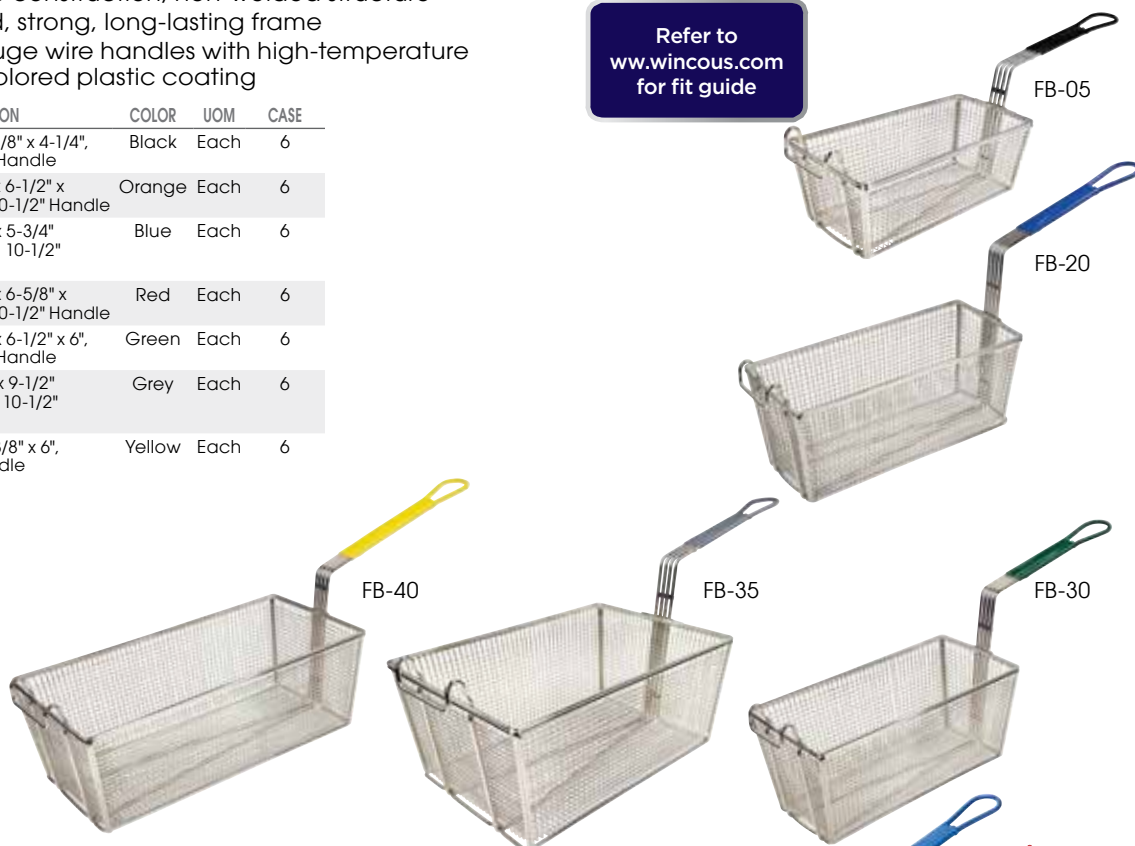

## SPECIALTY FRY BASKETS

- ◆ Heavy gauge wire handle coated with high-temperature resistant colored plastic
- ◆ Commercial quality 18/8 stainless steel

ITEM	DESCRIPTION	UOM	CASE
CKCF-BSK	8 Slots, Front Hook, 12-1/4" x 5-3/4" x 3-1/4" w/o hook, 10-1/2" L Handle	Each	10
FB-03	2 Hinged Shelves, Front & Side Hooks, 11-1/2" x 6" x 3-7/8" w/o hook, 8" L Handle	Each	6

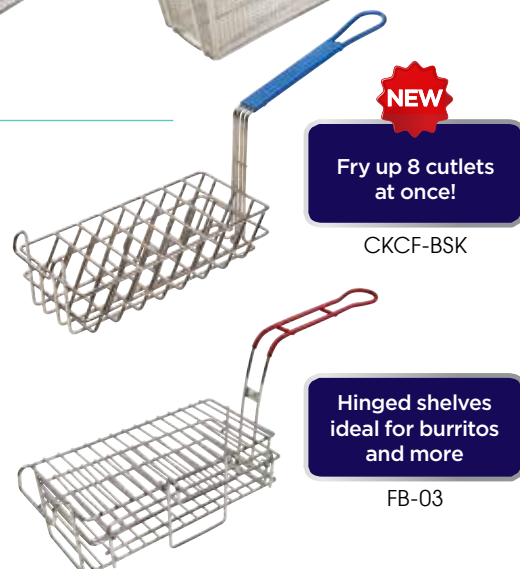

NEW

Fry up 8 cutlets  
at once!

CKCF-BSK

Hinged shelves  
ideal for burritos  
and more

FB-03

## CHROME-PLATED TORTILLA SHELL FRY BASKET

ITEM	DESCRIPTION	UOM	CASE
TB-25	25" Long Handle, 6-1/4" Dia Basket	Each	8

## NICKEL-PLATED TACO & TOSTADA BASKETS

ITEM	DESCRIPTION	UOM	CASE
TB-22	18" Hdl, Triangle Basket	Each	12
TB-20	18" Hdl, Round Basket	Each	12
TB-18	Tostada Basket, Eighteen 6" Tostada Shells	Each	8
TB-8	Taco Basket, Eight 6" Taco Shells	Each	8



## FRY BAGGERS & FILTER



FFBN-1R

FFBN-2

**NSF** FFBN-SERIES

### WINCO PRIME™ STAINLESS STEEL FRENCH FRY BAGGERS

- ◆ Removable handles for easy cleaning

ITEM	DESCRIPTION	UOM	CASE
FFBN-1R	Right Handle, NSF	Each	12/36
FFBN-2	Dual Handles, NSF	Each	12/36



FFB-1R

FFB-2

### FRENCH FRY BAGGERS

ITEM	DESCRIPTION	UOM	CASE
FFB-1R	Right Handle	Each	12/36
FFB-2	Dual Handles	Each	12/36



FF-10 &amp; FF-RC

### FRYER FILTER STAND & FILTER

- ◆ Cloth filters are heat resistant up to 392°F (200°C)

ITEM	DESCRIPTION	UOM	CASE
FF-10	10" Fryer Filter Stand	Each	20
FF-RC	Rayon Cloth Filter Cones (10-Pcs/ Box)	Box	1/60

## FRYER SPLASH GUARD



### 18 GAUGE, 18/8 STAINLESS STEEL FRYER SPLASH GUARD

- ◆ 20-1/2"L x 18"H
- ◆ Clips fit most fryers with 1 inch wide walls
- ◆ Use on either left or right side of fryer to prevent oil splashes on walls, floors or other equipment
- ◆ Easily detaches for cleaning

ITEM	DESCRIPTION	UOM	CASE
SFSG-2018	20-1/2"L x 18"H	Each	1/6



SFSG-2018

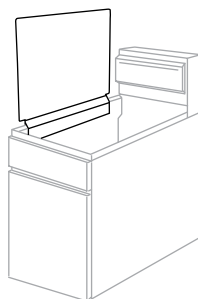

Use on either left or right of fryer

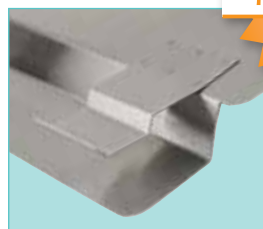

Clips fit 1" wide walls

**18/8**  
**Fits 1" Wall**  
**Stainless Steel**

## FRYER SCREEN

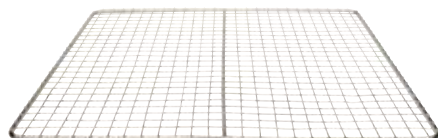

FS-1313

### CHROME-PLATED FRYER SCREEN

- ◆ For use with: Imperial: IFS-40; DCS: FRFG-40; American Range: AF-45; PITCO: 35C and 45C

ITEM	DESCRIPTION	UOM	CASE
FS-1313	13" x 13"	Each	12/48

Extra-heavyweight premium pasta baskets stand up to constantly knocking the edges when removing pasta. Water flows freely through the cylindrical design for even cooking. Hang-dry with the open-end handles. Most pasta cooker machines and standard stock pots will accommodate these baskets.

## PASTA BASKETS



### SUPER-FINE 18/8 STAINLESS STEEL MESH PASTA BASKETS

- ◆ Corrosion resistant electro-plating; reinforced frame
- ◆ Designed specifically for fine pastas, such as capellini and linguine

ITEM	DESCRIPTION	UOM	CASE
MPF-57	5"Dia x 7"H, Short	Each	1/8
MPF-59	5"Dia x 9"H, Tall	Each	1/8
MPF-67	6-1/2"Dia x 7"H, Wide	Each	1/8



MPF-67



MPF-59



MPF-57

### 18/8 STAINLESS STEEL MESH PASTA BOIL BASKETS

- ◆ Standard size mesh for cooking a variety of pastas

ITEM	DESCRIPTION	UOM	CASE
MPN-57	5-1/4" Dia x 7"H, Short	Each	2/8
MPN-59	5" Dia x 9"H, Tall	Each	2/8
MPN-67	6-1/2" Dia x 7"H, Wide	Each	2/6



MPN-67



MPN-59



MPN-57

### 18/8 STAINLESS STEEL BULK PASTA/IMMERSION BASKET

- ◆ Plastic coated handles rated for temperatures up to 250°F (120°C)
- ◆ Suitable for cooking most types of pasta in bulk
- ◆ Fits standard cookers

ITEM	DESCRIPTION	UOM	CASE
MPN-1613	16-1/4"L x 12-7/8"W x 10"H	Each	2



MPN-1613



### TAPERED ALUMINUM FRYER POTS

- ◆ Use hook on front of pan to secure fry basket to pot

ITEM	DESCRIPTION	SIZE	UOM	CASE
ALSP-5	5.5 Qt	10-1/8"Dia x 5-1/2"H	Each	6
ALSP-7	7 Qt	10-3/4"Dia x 5-1/2"H	Each	6
ALSP-10	10 Qt	11-1/2"Dia x 5-3/4"H	Each	6

### FRYER/PASTA COMBINATION PANS



ALSP-7

### NICKEL-PLATED 6MM WIRE MESH ROUND FRY BASKETS

- ◆ 1/8" mesh, ideal for small batch cooking/straining

ITEM	DESCRIPTION	HANDLE	UOM	CASE
FBRS-8	8-11/16"Dia x 4-15/16"H	7-1/4"	Each	20
FBRS-9	9-5/8"Dia x 4-15/16"H	7-1/4"	Each	20
FBRS-11	10-7/16"Dia x 5-5/16"H	9"	Each	20



FBRS-8

### NICKEL-PLATED 4MM WIRE MESH ROUND FRY BASKETS

- ◆ 1/4" mesh, ideal for small batch cooking/straining

ITEM	DESCRIPTION	HANDLE	UOM	CASE
FBR-8	8-1/2"Dia x 4-1/4"H	7-1/2"	Each	20
FBR-9	9-1/2"Dia x 5-3/4"H	8"	Each	20
FBR-11	10-1/2"Dia x 6"H	9"	Each	20



FBR-9

